



## 2 Bebdon Court, Blyth

£110,000

Semi Detached House • Open Plan Lounge • Fantastic Garden • Close to local amenities • Cul-De-Sac Location  
• Council tax band A • Viewings highly recommended • EPC to follow • Two Bedrooms • Kitchen Dining Room



We are delighted to bring this well presented two bedroom semi detached house, close to local amenities. The property briefly comprises of an entrance...

EPC Energy Efficiency Rating: E

EPC Environmental Impact Rating: D

**EXTERNALLY**

enclosed garden, gates for off street driveway, tap, lawn and paving

**BATHROOM**

Dimensions: 6' 5" x 5' 5" (1.97m x 1.66m). Frosted UPVC window to side, low level W/C, sink, radiator, panel bath with wall mounted shower

**BEDROOM TWO**

Dimensions: 11' 10" x 6' 10" (3.63m x 2.10m). UPVC window to front, radiator, storage cupboard

**LANDING**

Loft access, bathroom, two bedrooms

**BEDROOM ONE**

Dimensions: 11' 11" x 8' 7" (3.65m x 2.63m). UPVC window to rear, radiator

**LOUNGE**

Dimensions: 13' 7" x 11' 10" (4.15m x 3.62m). UPVC window to front, radiator, stairs to first floor

**MAIN DESCRIPTION**

We are delighted to bring this well presented two bedroom semi detached house, close to local amenities. The property briefly comprises of an entrance porch, open plan living room, kitchen/dining room with appliances and french doors opening onto the garden. To the first floor there are two bedrooms and a modern bathroom. Externally there is an impressive rear garden with driveway for off street parking option. Viewings recommended. This great starter home for first time buyers or investment purchasers.

**KITCHEN**

Dimensions: 11' 9" x 8' 6" (3.59m x 2.61m). UPVC window to rear, UPVC door to rear, radiator, wall and base units, stainless steel mixer tap, gas hob, electric oven, extractor fan, tiled splashbacks, wood effect rolled work surfaces, plumbing for washer, boiler cupboard









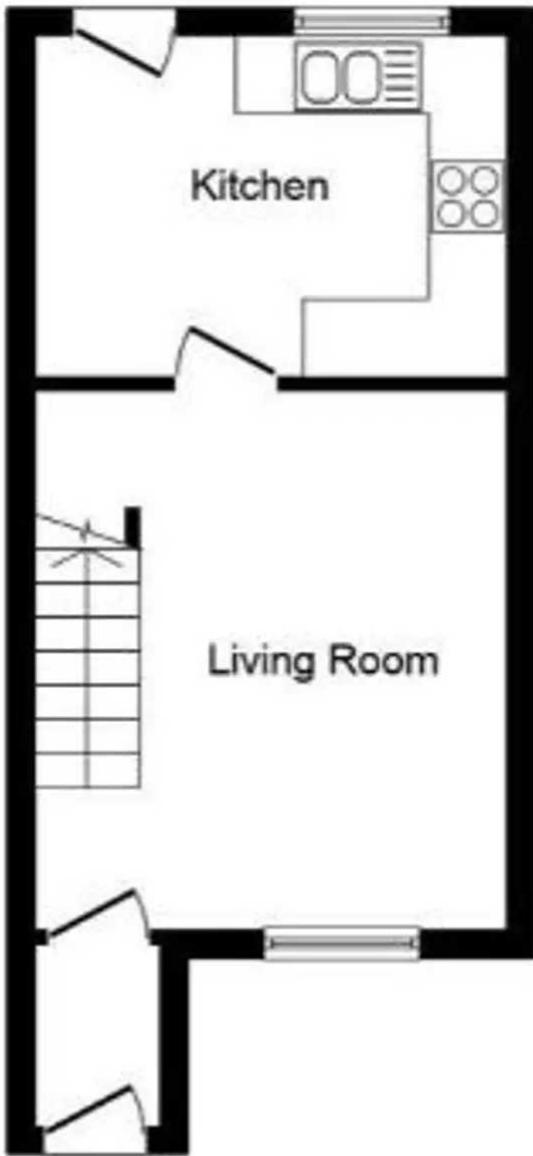

**Ground Floor**



**First Floor**

You can include any text here. The text can be modified upon generating your brochure.