



21 Queens Gardens, Blyth

£110,000 Freehold

Lennon Properties is pleased to present this three-bedroom semi-detached home to the sales market, ideally situated near transport links, schools, and local amenities. The property features a hallway, lounge, kitchen, and conservatory opening to the enclosed rear garden. The first floor comprises three bedrooms and a family bathroom. Externally, there is a shared driveway leading to a garage, and at the rear, an enclosed garden primarily laid to lawn. This home is perfect for expanding families or first-time buyers, and viewings are highly recommended.

Main description

Lennon Properties is pleased to present this three-bedroom semi-detached home to the sales market, ideally situated near transport links, schools, and local amenities. The property features a hallway, lounge, kitchen, and conservatory opening to the enclosed rear garden. The first floor comprises three bedrooms and a family bathroom. Externally, there is a shared driveway leading to a garage, and at the rear, an enclosed garden primarily laid to lawn. This home is perfect for expanding families or first-time buyers, and viewings are highly recommended.

Hallway

UPVC front door leading to stairs and access to the lounge.

Lounge

13' 4" x 13' 7" (4.07m x 4.13m)

UPVC window to the front, radiator and back boiler.

Kitchen/ Diner

16' 8" x 8' 1" (5.08m x 2.46m)

Two UPVC windows to the rear, UPVC door to the rear, spotlights, radiator, stainless steel sink with mixer tap, electric oven and hob, extractor hood, wall and base units, wooden effect roll top benches, tiled splash backs and plumbed for a washing machine.

Conservatory

10' 6" x 8' 8" (3.20m x 2.64m)

UPVC window to the sides, UPVC door with access to the garden and power points.

Landing

UPVC window to the side with access to the loft, three bedrooms and bathroom.

Bathroom

8' 0" x 7' 4" (2.45m x 2.23m)

Frosted UPVC window to the rear, vanity W/C and sink, chrome vertical towel warmer, panelled bath with over electric shower, storage cupboard and spotlights.

Bedroom one

11' 4" x 8' 11" (3.45m x 2.73m)

UPVC window to the rear and radiator.

Bedroom two

10' 5" x 8' 8" (3.18m x 2.65m)

UPVC window to the front and radiator.

Bedroom three

7' 8" x 6' 8" (2.34m x 2.04m)

UPVC window to the front.





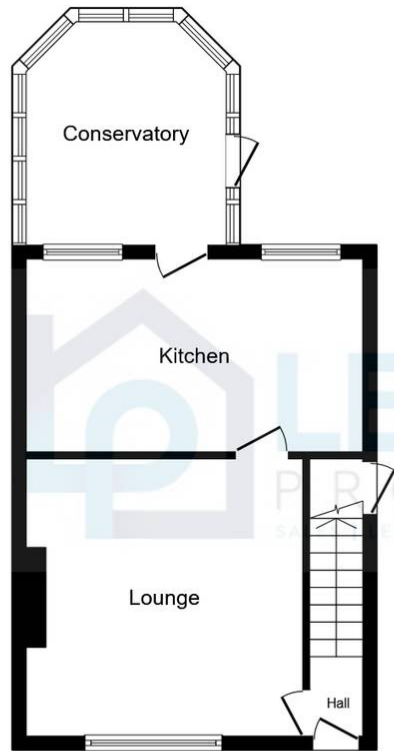

Ground Floor

Floor area 46.3 m² (499 sq.ft.)



First Floor

Floor area 36.2 m² (390 sq.ft.)

TOTAL: 82.5 m² (889 sq.ft.)

This floor plan is for illustrative purposes only. It is not drawn to scale. Any measurements, floor areas (including any total floor area), openings and orientations are approximate. No details are guaranteed, they cannot be relied upon for any purpose and do not form any part of any agreement. No liability is taken for any error, omission or misstatement. A party must rely upon its own inspection(s). Powered by www.Propertybox.io

