



3 Dukes Gardens, Blyth

£125,000 Freehold

Lennon Properties are delighted to present this extended three-bedroom semi-detached home to the sales market. Conveniently located near transport links, local amenities, and schools, this property offers an ideal living space for first-time buyers and growing families.

The ground floor features a porch, lounge, kitchen, utility room, and a downstairs shower room. On the first floor, there are three bedrooms and a newly fitted family bathroom.

Externally, the property boasts a driveway and garage, providing ample off-street parking, as well as enclosed front and back gardens. This property would be perfect for growing families and first time buyers.

Porch

UPVC front door, UPVC windows to the three sides.

Hallway

Door to the hallway, stairs with access to the lounge.

Lounge

14' 8" x 13' 4" (4.48m x 4.07m)

UPVC window to the front, radiator and gas fire.

Kitchen

15' 0" x 13' 0" (4.57m x 3.95m)

UPVC window to the rear, radiator, sink with mixer tap, wall and base units, plumbed for a washing dishwasher, gas hob, electric integrated oven and grill and door to the rear hallway.

Downstairs shower room

6' 11" x 3' 5" (2.11m x 1.04m)

Frosted UPVC window to the side, low level W/C, sink, electric shower and extractor.

Utility room

6' 9" x 3' 5" (2.07m x 1.03m)

Frosted UPVC window to the side, combi boiler and plumbed for a washing machine.

Rear hallway

Access to the shower room, kitchen and rear garden.

Landing

UPVC window to the side, access to the loft, family bathroom and the three bedrooms.

Bedroom one

12' 0" x 9' 10" (3.66m x 3.00m)

UPVC window to the front, radiator and fitted wardrobes.

Bedroom two

9' 9" x 8' 0" (2.96m x 2.45m)

UPVC window to the rear, radiator and fitted wardrobes.

Bedroom three

8' 2" x 6' 6" (2.50m x 1.99m)

UPVC window to the front and radiator.

Family bathroom

7' 0" x 5' 11" (2.13m x 1.81m)

Frosted UPVC window to the side, extractor, low level W/C, sink, towel warmer, panelled bath with over mains shower.







Ground Floor
Floor area 57.0 m² (614 sq.ft.)

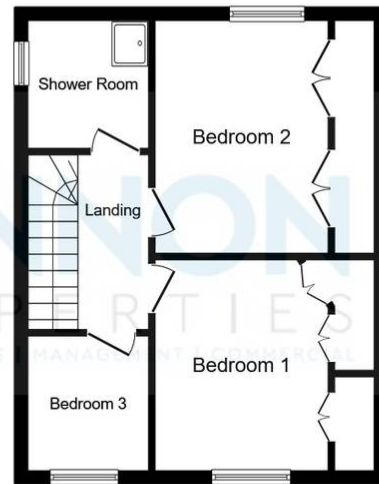

First Floor
Floor area 39.4 m² (424 sq.ft.)

TOTAL: 96.5 m² (1,038 sq.ft.)

This floor plan is for illustrative purposes only. It is not drawn to scale. Any measurements, floor areas (including any total floor area), openings and orientations are approximate. No details are guaranteed, they cannot be relied upon for any purpose and do not form any part of any agreement. No liability is taken for any error, omission or misstatement. A party must rely upon its own inspection(s). Powered by www.Propertybox.io

