



15 Shillhope Drive, Blyth

£149,950 Freehold

Lennon Properties is excited to present this impressive three-bedroom townhouse for sale. Conveniently situated near local transport, schools, and amenities, it's perfect for families and first-time homeowners. The property features a porch, living room, downstairs toilet, and a contemporary kitchen with French doors opening to the garden. The first floor houses a family bathroom and two spacious double bedrooms, while the top floor boasts a large master bedroom. Externally, there is an allocated parking space and a low-maintenance garden at the back. Viewings are highly recommended to fully appreciate everything this property has to offer.

Porch

Radiator, door access to lounge

Lounge

14' 9" x 11' 11" (4.50m x 3.63m)

UPVC window to the front, radiator, storage cupboard

Mid-hallway

Stairs, W/C cloaks, access to kitchen

WC / cloaks

3' 6" x 4' 4" (1.06m x 1.32m)

Low level wc, sink, extractor fan, radiator

Kitchen

11' 11" x 7' 9" (3.64m x 2.36m)

UPVC window to rear, UPVC french glass doors to the rear, spotlights, stainless steel sink with mixer tap, gas hob, electric oven, extractor hood, wood effect roll top surfaces, wall and base units, plumbed for washing machine and dishwasher, radiator.

Landing

Access to two bedrooms and the family bathroom.

Bedroom two

12' 0" x 10' 6" (3.65m x 3.20m)

Two UPVC windows to the front and radiator.

Bedroom three

12' 0" x 8' 10" (3.65m x 2.70m)

UPVC window to the rear and radiator.

Family bathroom

7' 10" x 5' 6" (2.40m x 1.68m)

Low level W/C, sink, extractor, spotlights, panelled bath with over main shower.

Bedroom one

23' 11" x 8' 6" (7.29m x 2.59m)

Two Velux windows to the front, one to the rear, radiator, storage cupboard and access to the loft.





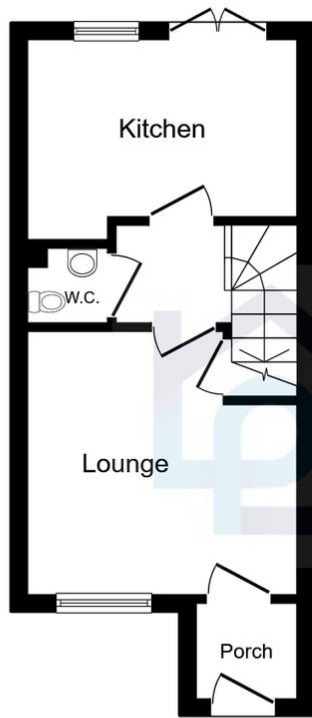

Ground Floor
 Floor area 24.0 sq.m. (258 sq.ft.)

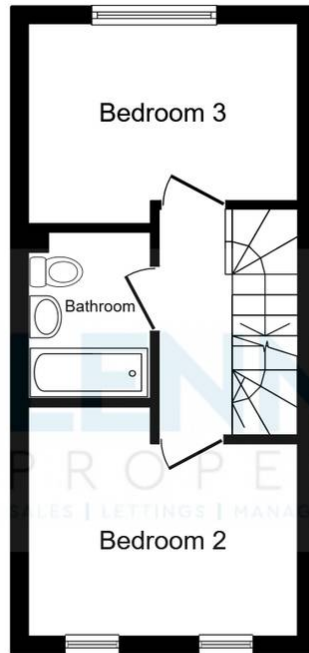

First Floor
 Floor area 24.8 sq.m. (267 sq.ft.)



Second Floor
 Floor area 17.3 sq.m. (186 sq.ft.)

TOTAL: 66.0 sq.m. (711 sq.ft.)

This floor plan is for illustrative purposes only. It is not drawn to scale. Any measurements, floor areas (including any total floor area), openings and orientations are approximate. No details are guaranteed, they cannot be relied upon for any purpose and do not form any part of any agreement. No liability is taken for any error, omission or misstatement. A party must rely upon its own inspection(s). Powered by www.Propertybox.io

You can include any text here. The text can be modified upon generating your brochure.



You can include any text here. The text can be modified upon generating your brochure.

