



22 Teal Avenue, Blyth

£185,000 Freehold

We are delighted to bring this immaculate three bedroom semi-detached home to the sales market, located close to the picturesque Blyth Beach, transport links, popular schools and local amenities makes it perfect for first time buyers or growing families. The property briefly comprises of porch, light and airy hallway, lounge, an impressive modern kitchen/diner with patio doors leading to the enclosed rear garden. To the first floor there is an impressive modern four piece bathroom and three bedrooms. This property also benefits from off street parking and a garage to the rear of the property. Viewing are highly recommended!

Porch

Composite front door, UPVC windows to the three sides, radiator and door to the hallway.

Hallway

Door to the front, UPVC windows to the side, radiator, stairs, and under stairs cupboard.

Lounge

13' 0" x 10' 8" (3.97m x 3.26m)

UPVC window to the front and radiator.

Kitchen/Diner

16' 10" x 11' 7" (5.14m x 3.52m)

UPVC window to the side, UPVC door to the rear, aluminium patio doors, spotlights, white vertical radiator, wall and base units, electric hob, extractor hood, marble effect surfaces, breakfast bar, one and a half stainless steel sink with mixer tap, integral double electric oven, washer and dishwasher.

Landing

UPVC window to the side, access to the loft with combi boiler, bathroom and three bedrooms.

Bedroom one

13' 1" x 10' 3" (3.98m x 3.12m)

UPVC window to the front, radiator and storage cupboard.

Bathroom

8' 6" x 6' 2" (2.60m x 1.87m)

Frosted UPVC window to the rear, spotlights, vertical chrome radiator, low level W/C, sink, panelled bath and mains walk in shower.

Bedroom two

9' 5" x 9' 0" (2.88m x 2.75m)

UPVC window to the rear, spotlights, radiator and fitted wardrobes.

Bedroom three

9' 9" x 6' 5" (2.97m x 1.96m)

UPVC window to the side, radiator, and storage cupboard.





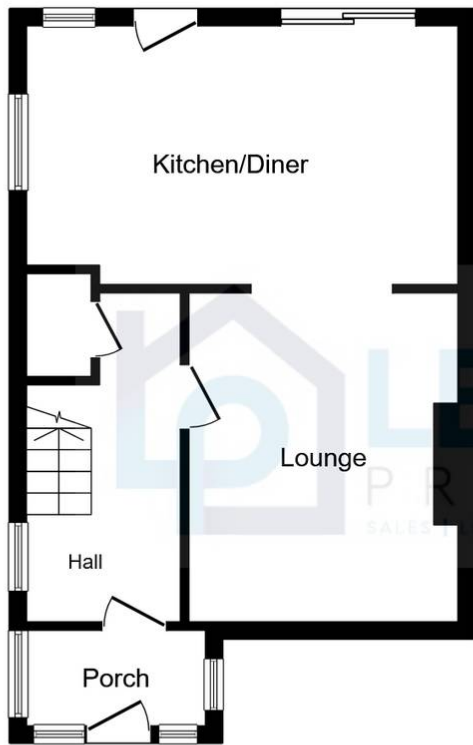

Ground Floor

Floor area 41.9 m² (451 sq.ft.)

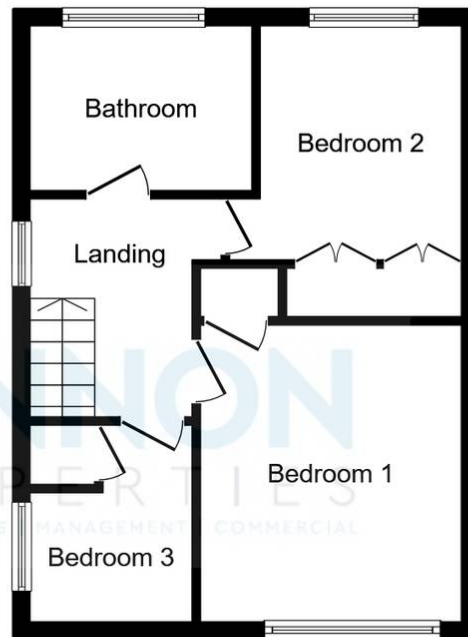

First Floor

Floor area 39.1 m² (421 sq.ft.)

TOTAL: 81.0 m² (872 sq.ft.)

This floor plan is for illustrative purposes only. It is not drawn to scale. Any measurements, floor areas (including any total floor area), openings and orientations are approximate. No details are guaranteed, they cannot be relied upon for any purpose and do not form any part of any agreement. No liability is taken for any error, omission or misstatement. A party must rely upon its own inspection(s). Powered by www.Propertybox.io

