

## 19 Shillhope Drive, Blyth

£225,000 Freehold

Lennon properties are excited to bring this immaculate three bedroom detached home, in the popular Crofton Grange. Close to major transport links, schools, and local amenities. The property briefly comprises of hallway, lounge, downstairs W/C, kitchen/diner with french doors leading to the rear garden and flooding the room with natural light and a utility room. To the first floor there are three double bedrooms, the primary bedroom also benefits from an en-suite and fitted wardrobes, there is also a family bathroom. To the exterior there is a front garden, and to the rear there is an enclosed rear garden with access to the garage and drive. Viewings are a must!

**Hallway**

Composite front door, UPVC window to the side, radiator, stairs, cupboard under the stairs, access to the W/C, lounge and kitchen.

**Lounge**

12' 11" x 12' 3" (3.94m x 3.73m)

UPVC window to the front and radiator.

**Downstairs W/C**

5' 4" x 3' 0" (1.62m x 0.92m)

Low level W/C, sink, radiator and extractor.

**Kitchen/Diner**

18' 1" x 9' 4" (5.52m x 2.84m)

UPVC window to the rear, UPVC french doors to the rear, radiator, spotlights, wall and base units, breakfast bar, tiled splash backs, gas hob, electric oven, extractor hood, one and a half stainless steel sink with mixer tap, integrated dishwasher and marble effect roll top benches.

**Utility room**

7' 8" x 5' 4" (2.33m x 1.62m)

Composite door to the side, base units, marble effect roll top benches, radiator, extractor, combi boiler, and plumbed for a washing machine.

**Landing**

UPVC window to the side, storage cupboard, access to the loft three bedrooms and family bathroom.

**Bedroom one**

11' 11" x 10' 9" (3.63m x 3.28m)

UPVC window to the front, radiator and fitted wardrobes

**En-suite**

6' 0" x 5' 10" (1.82m x 1.78m)

Frosted UPVC window to the front, extractor, low level W/C, sink, vertical chrome towel and mains shower.

**Bedroom two**

9' 6" x 9' 5" (2.89m x 2.88m)

UPVC window to the rear and radiator.

**Bedroom three**

9' 5" x 8' 4" (2.88m x 2.54m)

UPVC window to the rear and radiator.











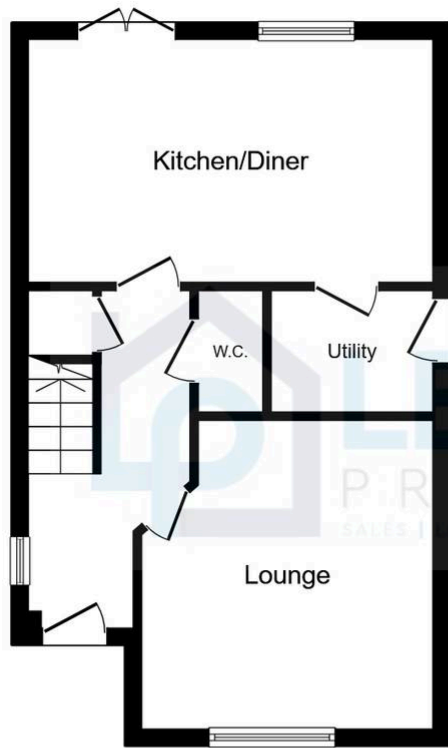

### Ground Floor

Floor area 40.8 m<sup>2</sup> (439 sq.ft.)

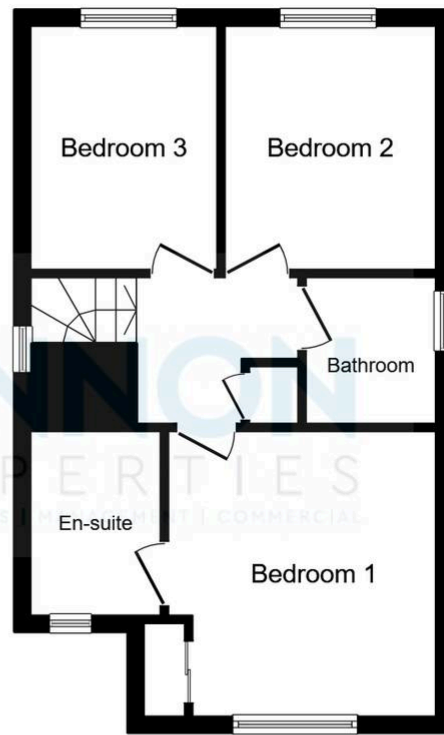

### First Floor

Floor area 40.8 m<sup>2</sup> (439 sq.ft.)

**TOTAL: 81.6 m<sup>2</sup> (879 sq.ft.)**

This floor plan is for illustrative purposes only. It is not drawn to scale. Any measurements, floor areas (including any total floor area), openings and orientations are approximate. No details are guaranteed; they cannot be relied upon for any purpose and do not form any part of any agreement. No liability is taken for any error, omission or misstatement. A party must rely upon its own inspection(s). Powered by [www.Propertybox.io](http://www.Propertybox.io)

