



Crofthead Close, Blyth

£139,950 Freehold

Introducing this very well presented three-bedroom end-terrace house in the popular area of Crofthead Close Blyth. From the moment you step through the front door, you are greeted with a sense of warmth and comfort, making it the ideal family home. The ground floor comprises a spacious living room, the kitchen/dining area is thoughtfully designed, providing ample space for family meals or gatherings. Downstairs WC completes the first floor. Ascending the stairs, you will find three bedrooms, all boasting a peaceful retreat at the end of each day. The family bathroom is modern and well-appointed, ensuring convenience for the whole household. The property benefits from an enclosed garden to the rear, providing a private outdoor space to enjoy some fresh air or host summer barbeques. Conveniently situated, residents can enjoy easy access to local amenities, schools, and transportation links. Whether you're looking to unwind at a nearby park, shop at local boutiques, or dine at charming eateries, everything you need is within reach. Viewings recommended to fully appreciate. Don't miss out

Entrance**Kitchen / Diner**

13' 7" x 11' 7" (4.14m x 3.53m)

Fitted with a range of base, wall and drawer units with roll top work surfaces. electric oven and gas hob with extractor over, stainless steel sink with mixer tap. tiled splash backs, window to the front.

Lounge

14' 9" x 11' 7" (4.50m x 3.52m)

Understair cupboard, French doors, double radiator and TV point.

Downstairs W.C

Comprising low level W.C, pedestal wash hand basin and UPVC window to the front.

Landing

Doors to three bedrooms and family bathroom.

Bedroom One

14' 9" x 9' 7" (4.49m x 2.93m)

Two UPVC windows to the front and single radiator.

Bedroom Two

9' 11" x 8' 4" (3.01m x 2.55m)

UPVC window to rear, single radiator and bed included.

Bedroom Three

6' 8" x 6' 6" (2.04m x 1.97m)

UPVC window to the rear, single radiator.

Bathroom

Three piece suite comprising low level W.C, pedestal wash hand basin and panelled bath with shower attachment over. UPVC frosted window and partly tiled. Extractor fan and single radiator.

Externally

Two parking bays to the front and enclosed rear garden.





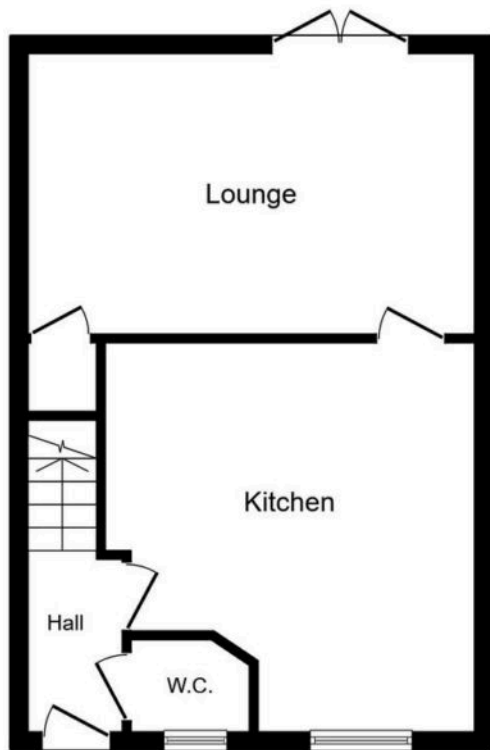

Ground Floor

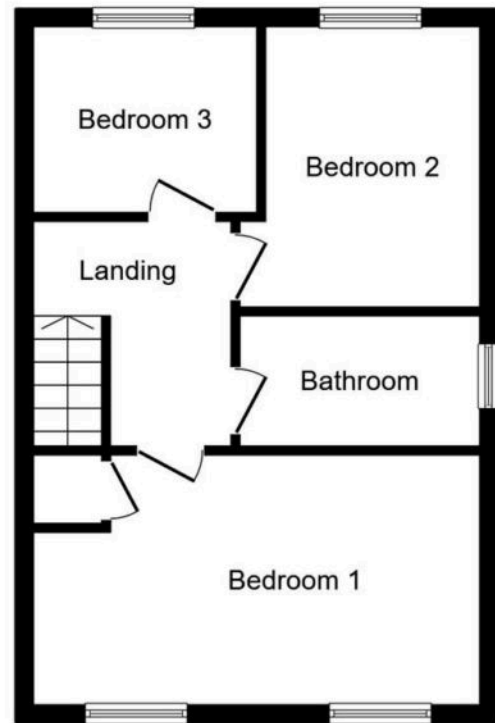

First Floor

This floor plan is for illustrative purposes only. It is not drawn to scale. Any measurements, floor areas (including any total floor area), openings and orientations are approximate. No details are guaranteed, they cannot be relied upon for any purpose and do not form any part of any agreement. No liability is taken for any error, omission or misstatement. A party must rely upon its own inspection(s). Powered by www.Propertybox.io

You can include any text here. The text can be modified upon generating your brochure.



You can include any text here. The text can be modified upon generating your brochure.

