

Chester Grove, Blyth

£135,000 Leasehold

This stunning three bedroom mid-terrace house presents an exceptional opportunity to secure a beautifully finished family home in a highly sought-after location. Superbly presented throughout, the property opens with a welcoming hallway that leads into a spacious lounge, perfect for relaxing evenings or entertaining guests. The heart of the home is the stylish breakfasting kitchen, thoughtfully designed with modern units, integrated appliances, and ample space for dining. Upstairs, three well-proportioned bedrooms offer comfortable accommodation for families or professionals alike, while a contemporary family bathroom boasts quality fixtures and a fresh, inviting atmosphere. Each room is tastefully decorated, creating a warm and inviting living environment that is ready to move straight into. Externally, the property continues to impress with its well-maintained outdoor spaces. To the front, a neatly lawned garden with attractive planted borders provides a welcoming first impression and a pleasant outlook. To the rear, a beautifully garden awaits, featuring a patio - ideal

ENTRANCE HALL

Central heating radiator, stairs to first floor, double doors to lounge.

LOUNGE

14' 5" x 13' 9" (4.39m x 4.18m)

Double glazed window, central heating radiator, storage cupboard,

KITCHEN/DINER

17' 9" x 10' 2" (5.40m x 3.10m)

Fitted with a range of wall and base units in beige high gloss with complementary work surfaces. Integrated induction hob with extractor, double oven, dishwasher and fridge freezer. Double glazed window, central heating radiator, Bifold doors to rear garden.

LANDING

Access to bedrooms, family bathroom, loft access, storage cupboard.

BEDROOM ONE

13' 1" x 10' 2" (4.00m x 3.10m)

Double glazed window, central heating radiator.

BEDROOM TWO

11' 2" x 10' 6" (3.40m x 3.20m)

Double glazed window, radiator.

BEDROOM THREE

10' 2" x 7' 3" (3.10m x 2.20m)

Double glazed window, storage cupboard, radiator.

FAMILY BATHROOM

Panelled bath with shower over, low level wc, wash hand basin, radiator, double glazed frosted window.





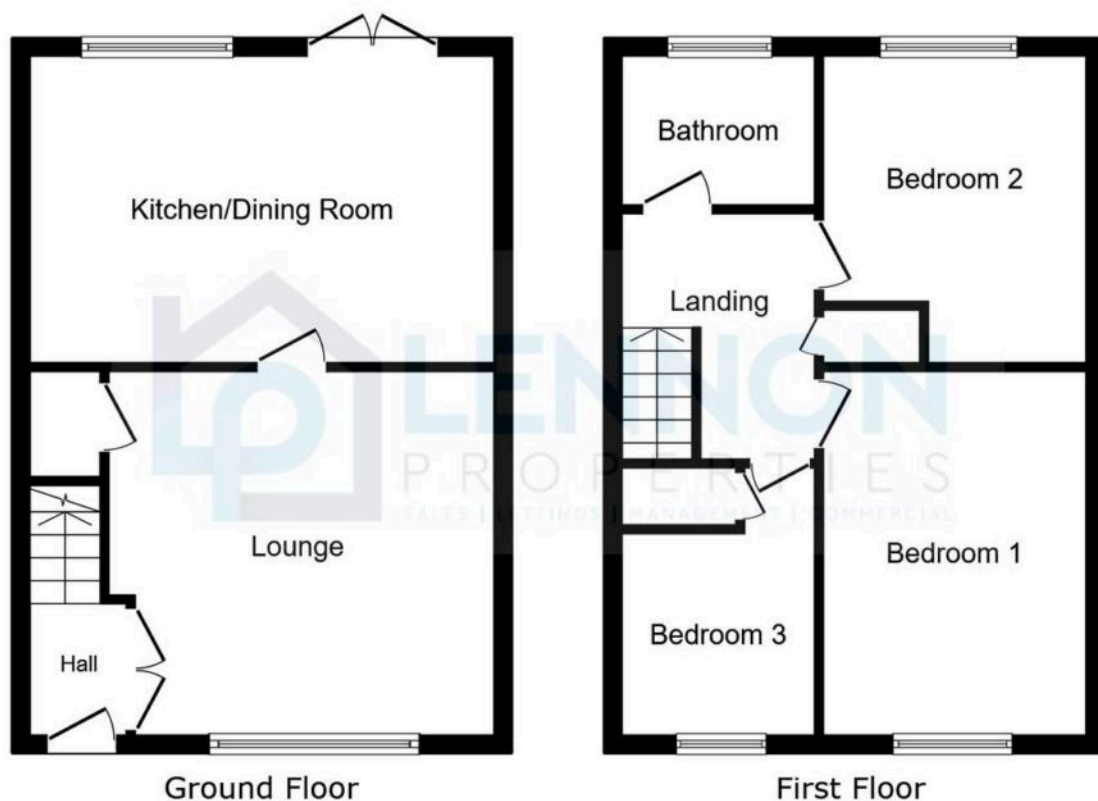

This floor plan is for illustrative purposes only. It is not drawn to scale. Any measurements, floor areas (including any total floor area), openings and orientations are approximate. No details are guaranteed, they cannot be relied upon for any purpose and do not form any part of any agreement. No liability is taken for any error, omission or misstatement. A party must rely upon its own inspection(s). Powered by www.Propertybox.io

You can include any text here. The text can be modified upon generating your brochure.



You can include any text here. The text can be modified upon generating your brochure.

